

DATE	REVISION
A 12.5.10	PLAN UPDATED FOLLOWING FSO SURVEY
B 10.10.12	EBG02 & EBG02a CONVERTED TO IT TRAINING ROOM
C 3.11.15	MAXIMUM CAPACITIES ADDED FOLLOWING REQUEST FROM FSO
D 14.4.16	MAIN SERVERY CLOSED + CAFE BAR AREA REFURBISHED.
E 5.7.16	EBG02 CONVERTED INTO TREADMILL ROOM FOR HSS.
F 22.9.16	EXTINGUISHER POSITIONS & TYPES UPDATED
G 23.5.17	ELECTRICAL SHUT-OFF POINT ADDED
H 18.10.18	UPDATE FOLLOWING REFURBISHMENT TO PROVIDE "ORI" FACILITY.

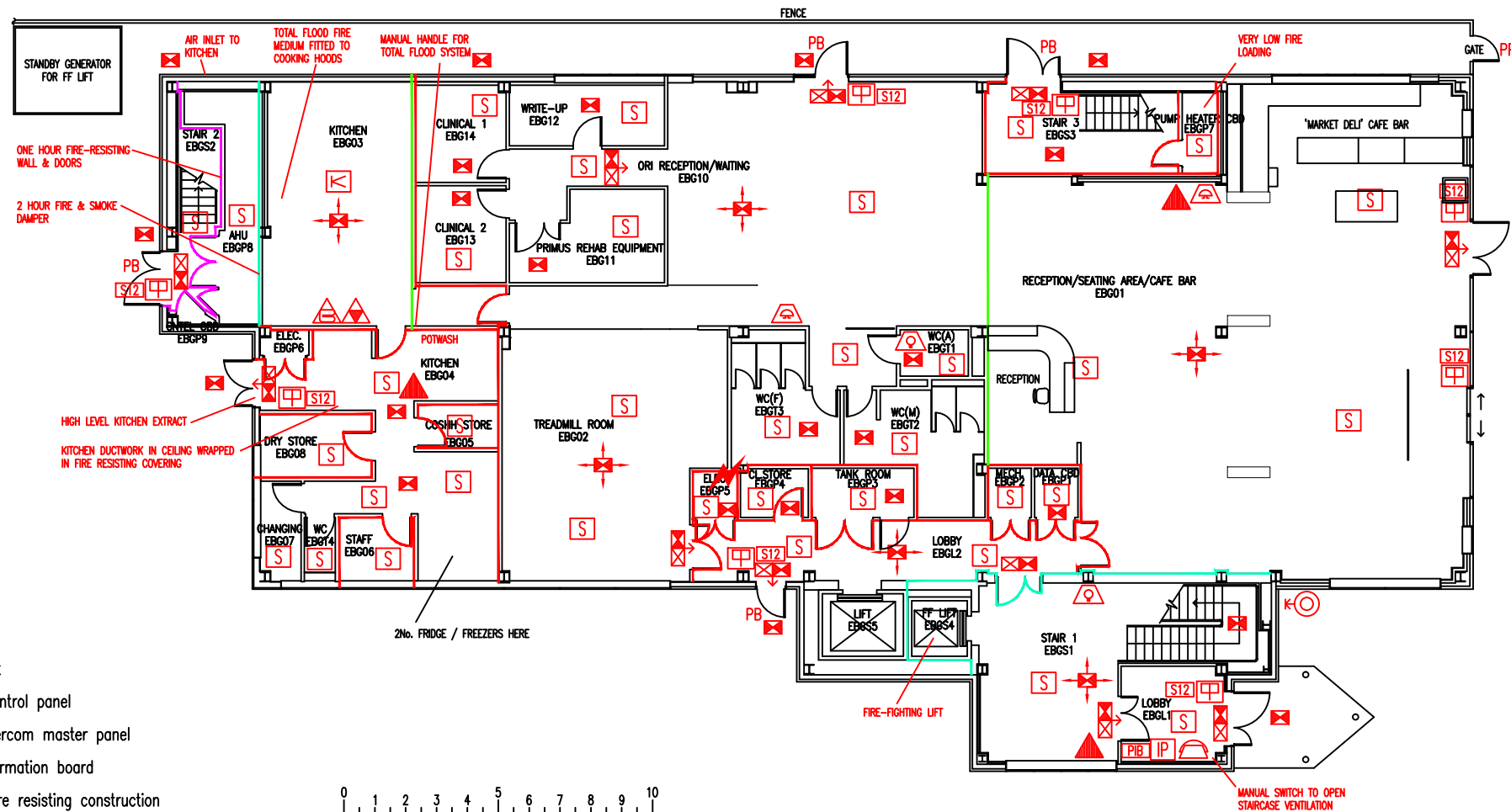

- Existing dry riser inlet
- Existing fire alarm control panel
- Wheelchair refuge intercom master panel
- Existing premises information board
- Existing 30-minute fire resisting construction
- Existing 1-hour fire resisting construction
- Existing 2-hour fire resisting partition
- Existing 30-minute fire resisting cavity barrier in ceiling & floor void
- Existing wet chemical fire extinguisher
- Existing 6 litre P50 foam fire extinguisher
- Existing fire blanket
- Existing call point - manual
- Existing audible warning device
- Existing visual warning device
- Existing smoke detector
- Existing heat detector
- Existing exit sign - internally illuminated
- Existing emergency lighting luminaire
- Existing fire action sign - general
- Existing pushpad door ironmongery
- Denotes directional arrow on existing fire exit sign
- Existing pushbar door ironmongery
- Area covered by existing emergency lighting
- Electrical shut-off point for building

THIS FIRE SAFETY PLAN IS GENERALLY BASED ON INFORMATION PROVIDED BY BU'S FIRE SAFETY OFFICER. IT IS THE RESPONSIBILITY OF ALL USERS OF THIS PLAN TO CHECK THE INFORMATION PROVIDED TO CONFIRM THE EXACT POSITIONS OF THE FIRE SAFETY EQUIPMENT, CAVITY BARRIERS ETC.

GROUND FLOOR
FIRE EQUIPMENT
PLAN

EXECUTIVE BUSINESS
CENTRE

EB/FP/1H

SCALE 1:200 at A3
NOVEMBER 2009

