

DATE	REVISION
A 7.6.06	P602-3 UPDATED
B 18.6.08	LOGO UPDATED. PLAN UPDATED FOLLOWING FSO'S SURVEY
C 28.9.10	UPDATE FOLLOWING FSO SURVEY
D 22.2.11	UPDATE FOLLOWING FSO SURVEY
E 14.4.15	UPDATE FOLLOWING Ph.1 REFORM. WORKS
F 27.9.16	EXTINGUISHER POSITIONS & TYPES UPDATED
G 4.4.19	UPDATE FOLLOWING SURVEY & WORKS TO CAVITY BARRIERS
H 25.4.23	UPDATE FOLLOWING ALTERATIONS TO P602 & P603.

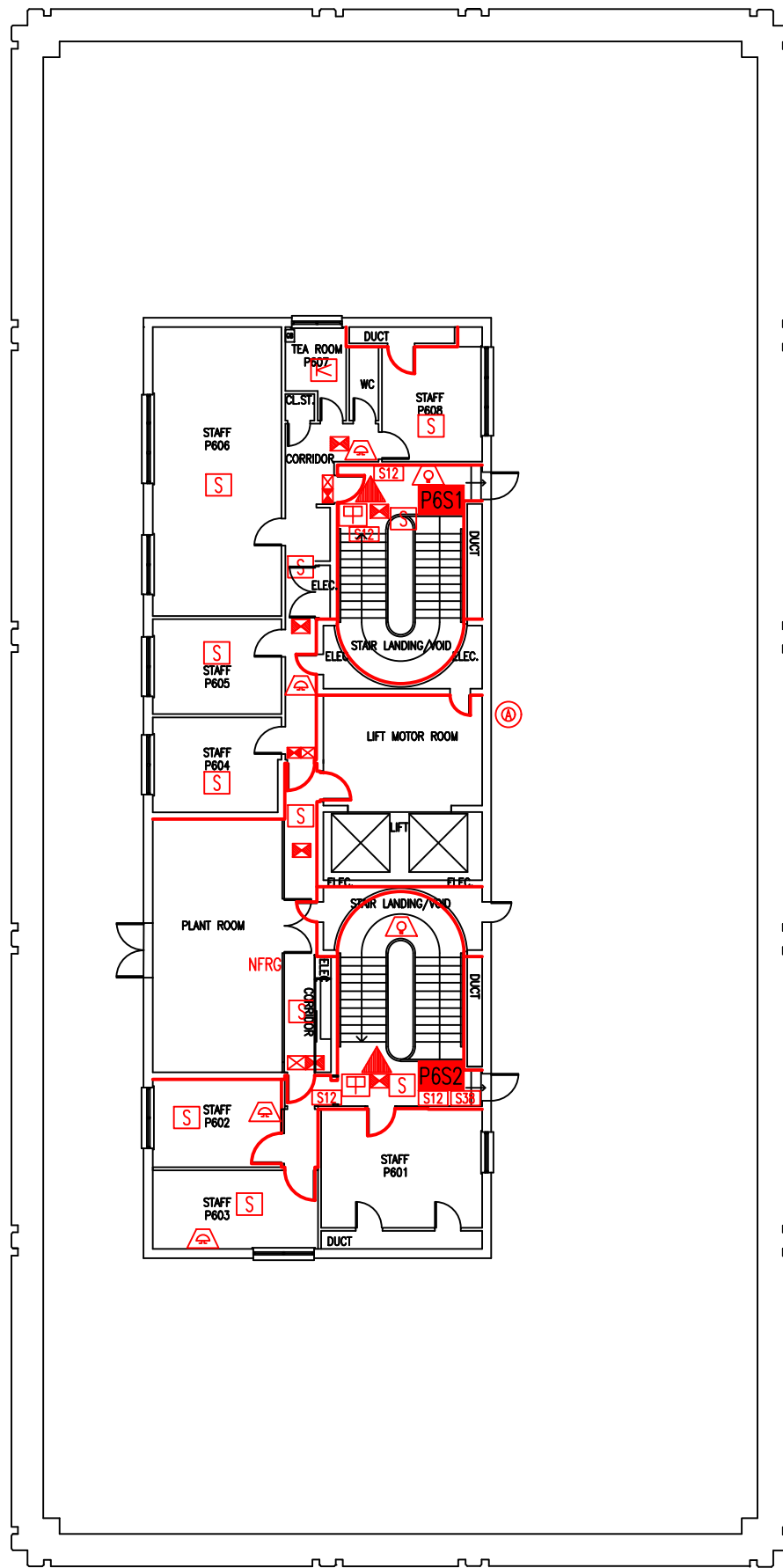

- Key to Fire Symbols
- Existing fire resisting construction 30 min.
 - Existing wheelchair refuge zone
 - Existing air valve for dry riser
 - Existing exit sign – internally illuminated
 - Existing emergency lighting luminaire
 - Existing 6 litre P50 foam fire extinguisher
 - Existing call point – manual
 - Existing audible warning device
 - Existing visual warning device
 - Existing smoke detector
 - Existing heat detector
 - Non fire-resisting glazed element
 - Existing fire action sign – general
 - Existing fire plan

THIS FIRE SAFETY PLAN IS GENERALLY BASED ON INFORMATION PROVIDED BY BU'S FIRE SAFETY OFFICER. IT IS THE RESPONSIBILITY OF ALL USERS OF THIS PLAN TO CHECK THE INFORMATION PROVIDED TO CONFIRM THE EXACT POSITIONS OF THE FIRE SAFETY EQUIPMENT, CAVITY BARRIERS ETC.

SIXTH FLOOR
FIRE PLAN

POOLE HOUSE:
MAIN BLOCK

PH/M/FP/7H

SCALE 1:200 at A3
SEPTEMBER 2005

