

DATE	REVISION
A 18.5.10	PLAN UPDATED FOLLOWING FSO SURVEY
B 1.10.12	CALL POINT ADDED IN STAIR 1
C 23.9.16	EXTINGUISHER POSITIONS & TYPES UPDATED
D 23.5.17	ELECTRICAL SHUT-OFF POINT ADDED
E 26.9.17	RG01 UPDATED TO 'VACANT (staff)'
F 17.9.18	RG01 UPDATED TO 'MEETING ROOM'

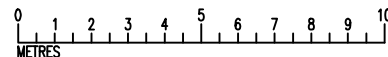
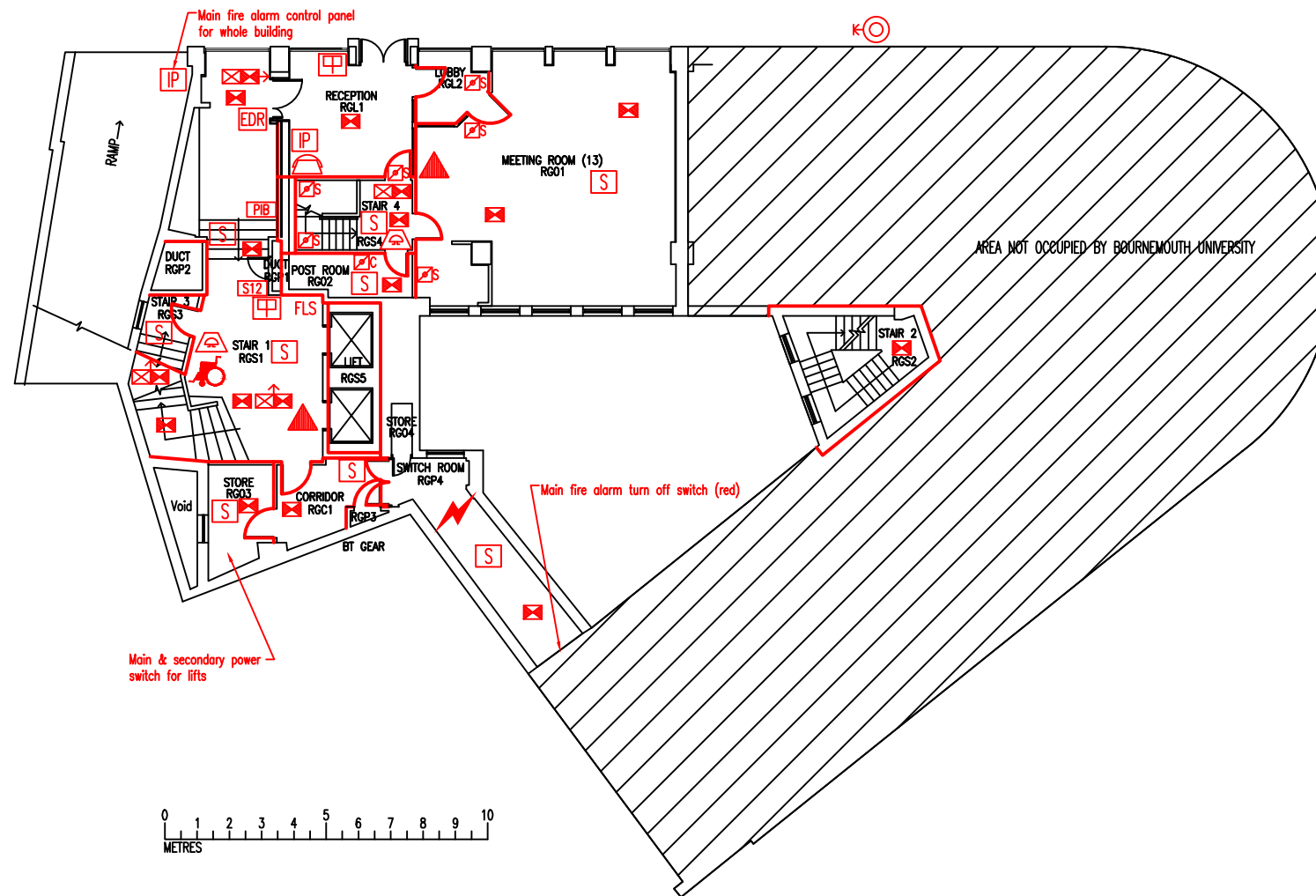

- Key to Fire Symbols
- Existing fire resisting construction 30 min.
  - Existing Evac chair
  - Wheelchair refuge intercom master panel
  - Existing fire alarm control panel
  - Existing dry riser inlet box
  - Existing smoke damper in duct
  - Existing premises information board
  - Existing fire alarm control panel
  - Existing fire damper control box
  - Existing fire fighting lift switch
  - Existing 6 litre P50 foam fire extinguisher
  - Existing call point - manual
  - Existing exit sign - internally illuminated
  - Existing emergency lighting luminaire
  - Existing smoke detector
  - Denotes directional arrow on existing fire exit sign
  - Existing fire action sign - general
  - Existing audible warning device
  - Existing emergency door release call point - manual
  - Electrical shut-off point for building

THIS FIRE SAFETY PLAN IS GENERALLY BASED ON INFORMATION PROVIDED BY BU'S FIRE SAFETY OFFICER. IT IS THE RESPONSIBILITY OF ALL USERS OF THIS PLAN TO CHECK THE INFORMATION PROVIDED TO CONFIRM THE EXACT POSITIONS OF THE FIRE SAFETY EQUIPMENT, CAVITY BARRIERS ETC.

GROUND FLOOR  
FIRE EQUIPMENT  
PLAN

ROYAL LONDON  
HOUSE

RLH/FP/GF

SCALE 1:200 at A3  
JUNE 2008

